

DEWEI CARBIDE

硬质合金棒材

Carbide Rods



浙江德威硬质合金制造有限公司
ZHEJIANG DEWEI CEMENTED CARBIDE MANUFACTURING CO.,LTD

关于德威

About DEWEI

浙江德威硬质合金制造有限公司,是中国上市公司格林美股份有限公司的控股子公司,位于中国的浙江省温州市,距离上海港口430KM,距离宁波港200KM,交通便利,区域经济发达。主要从事硬质合金的生产,拥有从钨矿(钨废料)开始,到APT,碳化钨粉料,硬质合金产品为止的全产业生产线。

母公司格林美集团建立了国家级的技术研究中心,拥有国际一流的工艺技术、生产设备和检测仪器;德威公司依托集团优势,研发各类高性能硬质合金产品,拥有一支锐意进取的高素质员工队伍。

公司坚持以人为本,客户至上,合作共赢的宗旨,服务于国内外客户,为客户带来更大的价值。

Zhejiang Dewei Cemented Carbide Manufacturing Co., Ltd.(Dewei Carbide) is a fully integrated manufacturing organization, which offers a wide range of Tungsten Carbide products, from premium raw materials, inserts and carbide rods & blanks to customization. Both our Tungsten Powder Plant and Carbide Manufacturing Factory in China are ISO9001 certified.

For over 15 years, we have been serving customers worldwide. Our dedicated team is determined to provide best customer service possible.

In 2014, Dewei Carbide joined GEM China Group, one of the largest public companies in the resource recycling industry in China. This merge gives Dewei Carbide access to GEM's state-level metallurgical laboratories with state-of-the-art equipment and technologies, which greatly enhanced our innovation and quality control capabilities.



德威产业链
DEWEI Product Line



钨矿石
Tungsten Concentrates



仲钨酸胺 APT
(Ammonium Paratungstate)



碳化钨粉末
WC Powder



RTP 粉末
RTP Powder

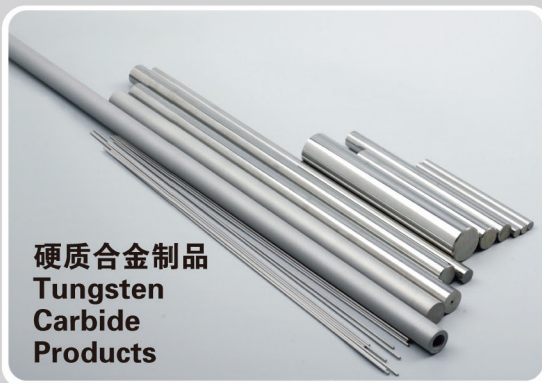

硬质合金制品
Tungsten
Carbide
Products

以**真诚**连结客户，以**创新**架构未来

Contacting customers with sincerity, and
creating the future by innovation

牌号介绍 Grade Information

企业牌号 Grade	ISO 牌号 ISO Grade	晶粒度 Grain Size (μm)	钴含量 Cobalt Content (%)	硬度 Hardness (HRA)	密度 Density (g/cm^3)	抗弯强度 T.R.S (N/mm^2)	用途
DU10UF	K05-K10	0.4	6.0	94.0	14.80	3500	适用于制作高耐磨性的铣刀、雕刻刀，可用于加工 PCB 和复合材料。 Recommend for high wear resistance endmills and engraving tools. Suitable for cutting PCB and composite materials.
DU15UF	K10-K20	0.4	8.5	93.5	14.50	3500	适用于制作高耐磨性的铣刀、雕刻刀，可用于加工 PCB 和塑胶板。 Recommend for high wear resistance endmills and engraving tools. Suitable for cutting PCB and plastic plates.
DU20F	K20-K30	0.6	10.3	92.5	14.40	3800	适用于制作立铣刀和钻头，可用于加工普通合金钢 (HRC < 55)、不锈钢、灰口铸铁 & 耐热合金。 Recommend for endmills and solid drills. Suitable for cutting general steel (HRC < 55), stainless steel, grey cast iron & heat resistant alloy.
DU25	K20-K30	0.5	12.0	92.5	14.20	4000	耐磨性好，韧性优异的亚微晶合金牌号，适用于制作高速工具铣刀，各种立铣刀，铰刀等。可用于加工 55HRC 以下钛合金、高硬铝合金、淬硬钢、耐热合金、不锈钢、玻璃纤维增强塑料等材料铣削加工。 Good antiweariness and toughness. Recommended for making high-speed tooling routers, endmills, reamers etc. Suitable for machining 55HRC max. titanium alloy, high-hardness aluminum alloy, heat-treated steel, heat-resistant alloy, stainless steel, glass fiber reinforced plastic and so on.
DU20	K20-K30	0.8	10.0	91.8	14.40	3800	适用于制作立铣刀和钻头，可用于加工普通合金钢 (HRC < 48)、不锈钢、灰口铸铁 & 耐热合金。 Recommend for endmills and solid drills. Suitable for cutting general steel (HRC < 48), stainless steel, grey cast iron & heat resistant alloy.

DEWEL

公制长棒 Solid Rods-Metric



毛坯 Unground



精磨 Ground



直径 ΦD	3	4	5	6	7	8	9	10	11	12	13
长度 L	330	330	330	330	330	330	330	330	330	330	330
直径 ΦD	14	16	17	18	19	20	21	22	24	25	
长度 L	330	330	330	330	330	330	330	330	330	330	

单位 unit (mm)

公差 Tolerance	毛坯 Unground ΦD (mm)		精磨 Ground ΦD (mm)		长度 L(mm)
	范围 (Range)	公差 (Tol.)	范围 (Range)	公差 (Tol.)	公差 (Tol.)
	$2 \leq \Phi D < 3$	+0.15,+0.30	$2 \leq \Phi D < 42$	h5/h6	0,+5
	$3 \leq \Phi D < 6$	+0.30,+0.50			
	$6 \leq \Phi D < 12$	+0.30,+0.60			
	$12 \leq \Phi D < 16$	+0.30,+0.70			
$16 \leq \Phi D < 25$	+0.30,+0.80				

英制长棒 Solid Rods-Inch

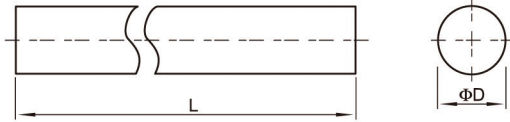

毛坯 Unground



精磨 Ground



直径 ΦD	1/8	9/64	5/32	11/64	3/16	13/64	7/32	15/64	1/4	9/32	19/64	5/16	21/64	11/32	23/64	3/8	25/64
长度 L	13-1/8	13-1/8	13-1/8	13-1/8	13-1/8	13-1/8	13-1/8	13-1/8	13-1/8	12-1/8	12-1/8	12-1/8	12-1/8	12-1/8	12-1/8	12-1/8	12-1/8
直径 ΦD	13/32	27/64	7/16	29/64	15/32	31/64	1/2	17/32	9/16	5/8	11/16	3/4	13/16	7/8	15/16	1.	
长度 L	12-1/8	12-1/8	12-1/8	12-1/8	12-1/8	12-1/8	12-1/8	12-1/8	12-1/8	12-1/8	12-1/8	12-1/8	12-1/8	12-1/8	12-1/8	12-1/8	

单位 unit (Inch)

公差 Tolerance	毛坯 Unground ΦD(Inch)		精磨 Ground ΦD(Inch)		长度 L(Inch)
	范围 (Range)	公差 (Tol.)	范围 (Range)	公差 (Tol.)	公差 (Tol.)
	$1/8 \leq \Phi D \leq 1/4$	+0.012,+0.020	$1/8 \leq \Phi D \leq 1$	h5/h6	+1/8,+3/8
	$1/4 < \Phi D \leq 31/64$	+0.012,+0.024			
	$31/64 < \Phi D \leq 5/8$	+0.012,+0.028			
	$5/8 < \Phi D \leq 1$	+0.012,+0.032			

DEWEI

精磨倒角短棒 Ground Rods with Chamfer

公制精磨倒角短棒(h5/h6)

Ground Rods with Chamfer-Metric(h5/h6)

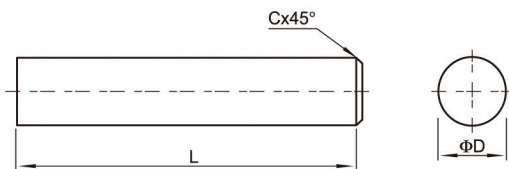

直径 ΦD	长度 L (公差 Tol./0,+1)	倒角尺寸 C (公差 Tol./ ± 0.1)	倒角角度 Angle of Chamfer (公差 Tol./ ± 3°)
3	40	0.4	45°
3	50	0.4	45°
3	70	0.4	45°
3	100	0.4	45°
3	150	0.4	45°
4	40	0.4	45°
4	50	0.4	45°
4	75	0.4	45°
4	100	0.4	45°
4	150	0.4	45°
5	50	0.5	45°
5	55	0.5	45°
5	60	0.5	45°
5	70	0.5	45°
5	80	0.5	45°
5	100	0.5	45°
5	150	0.5	45°
6	50	0.5	45°
6	60	0.5	45°
6	75	0.5	45°
6	10	0.5	45°
6	150	0.5	45°
7	55	0.6	45°
7	60	0.6	45°
8	60	0.6	45°
8	75	0.6	45°

单位 unit (mm)

续 /continued

精磨倒角短棒 Ground Rods with Chamfer

公制精磨倒角短棒(h5/h6)
Ground Rods with Chamfer–Metric(h5/h6)

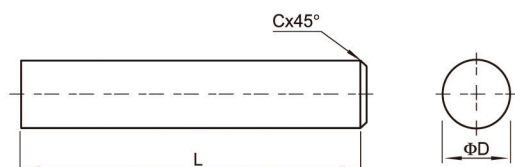

直径 ΦD	长度 L (公差 Tol./0,+1)	倒角尺寸 C (公差 Tol./ ± 0.1)	倒角角度 Angle of Chamfer (公差 Tol./ ± 3°)
8	80	0.6	45°
8	90	0.6	45°
8	100	0.6	45°
8	150	0.6	45°
10	70	0.6	45°
10	75	0.6	45°
10	90	0.6	45°
10	100	0.6	45°
10	125	0.6	45°
11	110	0.8	45°
12	75	0.8	45°
12	90	0.8	45°
12	100	0.8	45°
12	120	0.8	45°
14	75	0.8	45°
14	110	0.8	45°
14	125	0.8	45°
16	100	0.8	45°
16	125	0.8	45°
18	100	0.8	45°
18	150	0.8	45°
20	100	1.0	45°
20	120	1.0	45°
20	150	1.0	45°
25	100	1.0	45°
25	150	1.0	45°

单位 unit (mm)

精磨倒角短棒 Ground Rods with Chamfer

英制精磨倒角短棒(h5/h6)

Ground Rods with Chamfer-Inch(h5/h6)

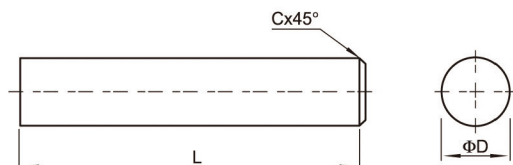

直径 ΦD	长度 L (公差 Tol./0,+1)	倒角尺寸		倒角角度 Angle of Chamfer (公差 Tol./ ± 3°)
		C	公差 Tol.	
1/8	1-1/2	0.015	± 0.004	45°
1/8	2	0.015	± 0.004	45°
1/8	2-1/2	0.015	± 0.004	45°
1/8	3	0.015	± 0.004	45°
3/16	2	0.015	± 0.004	45°
3/16	3	0.015	± 0.004	45°
1/4	2	0.015	± 0.004	45°
1/4	2-1/2	0.015	± 0.004	45°
1/4	3	0.015	± 0.004	45°
1/4	4	0.015	± 0.004	45°
5/16	2-1/2	0.015	± 0.004	45°
3/8	2-1/2	0.015	± 0.004	45°
3/8	3	0.015	± 0.004	45°
1/2	2-1/2	0.031	± 0.008	45°
1/2	3	0.031	± 0.008	45°
1/2	4	0.031	± 0.008	45°
5/8	3-1/2	0.031	± 0.008	45°
3/4	4	0.031	± 0.008	45°
3/4	5	0.031	± 0.008	45°
1.	4	0.031	± 0.008	45°

单位 unit (Inch)

精磨倒角短棒 Ground Rods with Chamfer

DIN 精磨倒角短棒(h5/h6)
Ground Rods with Chamfer-DIN(h5/h6)

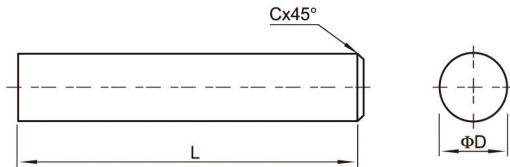

● 应用于铣刀 For End Mills

直径 ΦD	长度 L (公差 Tol./0,+1)	倒角尺寸 C (公差 Tol./ ± 0.1)	倒角角度 Angle of Chamfer (公差 Tol./ ± 3°)
3	38	0.4	45°
3.5	50	0.4	45°
4	50	0.4	45°
4.5	50	0.5	45°
5	50	0.5	45°
5.5	57	0.5	45°
6	50	0.5	45°
6	57	0.5	45°
6	54	0.5	45°
6.5	60	0.6	45°
7	60	0.6	45°
7.5	63	0.6	45°
8	58	0.6	45°
8	63	0.6	45°
8.5	67	0.6	45°
9	67	0.6	45°

单位 unit (mm)

续 /continued

DEWEI

精磨倒角短棒 Ground Rods with Chamfer

DIN 精磨倒角短棒(h5/h6)

Ground Rods with Chamfer-DIN(h5/h6)

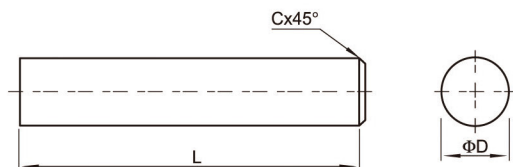

● 应用于铣刀 For End Mills

直径 ΦD	长度 L (公差 Tol./0,+1)	倒角尺寸 C (公差 Tol./ ± 0.1)	倒角角度 Angle of Chamfer (公差 Tol./ ± 3°)
9.5	72	0.6	45°
10	66	0.6	45°
10	72	0.6	45°
11	83	0.8	45°
12	73	0.8	45°
12	83	0.8	45°
13	83	0.8	45°
14	75	0.8	45°
14	83	0.8	45°
15	92	0.8	45°
16	82	0.8	45°
16	92	0.8	45°
18	84	0.8	45°
18	92	0.8	45°
20	92	1.0	45°
20	104	1.0	45°

单位 unit (mm)

精磨倒角短棒 Ground Rods with Chamfer

DIN 精磨倒角短棒(h5/h6)
Ground Rods with Chamfer-DIN(h5/h6)

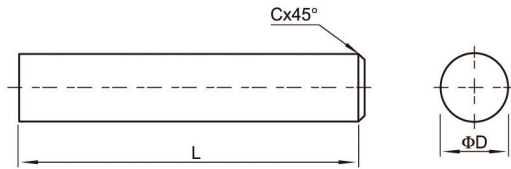

● 应用于钻头 For Solid Drill

直径 ΦD	长度 L (公差 Tol./0,+1)	倒角尺寸 C (公差 Tol./ ± 0.1)	倒角角度 Angle of Chamfer (公差 Tol./ ± 3°)
3	47	0.4	45°
4	56	0.4	45°
5	63	0.5	45°
6	63	0.5	45°
6	67	0.5	45°
6	75	0.5	45°
6	83	0.5	45°
7	75	0.5	45°
8	80	0.6	45°
8	92	0.6	45°
9	85	0.6	45°
10	90	0.6	45°
10	104	0.6	45°
11	96	0.6	45°
12	103	0.8	45°
12	119	0.8	45°
13	103	0.8	45°
14	108	0.8	45°
14	125	0.8	45°
15	112	0.8	45°
16	116	0.8	45°
16	134	0.8	45°
17	120	0.8	45°
18	124	0.8	45°
18	144	0.8	45°
19	128	1.0	45°
20	132	1.0	45°
20	154	1.0	45°

单位 unit (mm)

单直孔棒材 Rods with Central Coolant Hole



直径 Diameter			长度 L (公差 Tol./0,+5)	内孔径 Hole Diameter		孔中心 偏离 a
ΦD	毛坯公差 Tol./of Unground	精品公差 Tol./of Ground		ΦD	公差 Tol.	
3	+0.30,+0.50	h6	330	0.50	± 0.10	0.10
4	+0.30,+0.50	h6	330	0.80	± 0.10	0.10
5	+0.30,+0.50	h6	330	0.80	± 0.10	0.13
6	+0.30,+0.50	h6	330	1.00	± 0.15	0.15
7	+0.30,+0.60	h6	330	1.00	± 0.15	0.15
8	+0.30,+0.60	h6	330	1.00	± 0.15	0.15
9	+0.30,+0.60	h6	330	1.40	± 0.15	0.20
10	+0.30,+0.60	h6	330	1.40	± 0.15	0.20
11	+0.30,+0.60	h6	330	1.40	± 0.15	0.28
12	+0.30,+0.60	h6	330	1.75	± 0.15	0.30
13	+0.30,+0.70	h6	330	1.75	± 0.15	0.34
14	+0.30,+0.70	h6	330	1.75	± 0.15	0.37
15	+0.30,+0.70	h6	330	2.00	± 0.20	0.40
16	+0.30,+0.70	h6	330	2.00	± 0.20	0.40
17	+0.30,+0.80	h6	330	2.00	± 0.20	0.47
18	+0.30,+0.80	h6	330	2.00	± 0.20	0.50
19	+0.30,+0.80	h6	330	2.00	± 0.20	0.50
20	+0.30,+0.80	h6	330	2.50	± 0.25	0.50
21	+0.30,+0.80	h6	330	2.50	± 0.25	0.50
22	+0.30,+0.80	h6	330	2.50	± 0.25	0.50
23	+0.30,+0.80	h6	330	2.50	± 0.25	0.50
24	+0.30,+0.80	h6	330	3.00	± 0.25	0.50
25	+0.30,+0.80	h6	330	3.00	± 0.25	0.50

单位 unit (mm)

双直孔棒材 Rods with Two Straight Coolant Holes

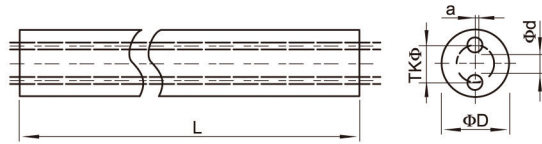

直径 Diameter			长度 L (公差 Tol./0,+5)	内孔径 Hole Diameter		孔间距 Bolt Circle		孔中心 偏离 a
ΦD	毛坯公差 Tol./of Unground	精品公差 Tol./of Ground		ΦD	公差 Tol.	TKΦ	公差 Tol.	
4	+0.30,+0.50	h6	330	0.80	± 0.10	1.80	+0,-0.15	0.10
5	+0.30,+0.50	h6	330	0.80	± 0.10	2.00	+0,-0.15	0.13
6	+0.30,+0.50	h6	330	1.00	± 0.15	3.00	+0,-0.20	0.15
7	+0.30,+0.60	h6	330	1.00	± 0.15	3.50	+0,-0.20	0.15
8	+0.30,+0.60	h6	330	1.00	± 0.15	4.00	+0,-0.30	0.15
9	+0.30,+0.60	h6	330	1.40	± 0.15	4.00	+0,-0.30	0.20
10	+0.30,+0.60	h6	330	1.40	± 0.15	5.00	+0,-0.30	0.20
11	+0.30,+0.60	h6	330	1.40	± 0.15	5.00	+0,-0.30	0.28
12	+0.30,+0.60	h6	330	1.75	± 0.15	6.00	+0,-0.30	0.30
13	+0.30,+0.70	h6	330	1.75	± 0.15	6.00	+0,-0.30	0.34
14	+0.30,+0.70	h6	330	1.75	± 0.15	7.00	+0,-0.30	0.37
15	+0.30,+0.70	h6	330	2.00	± 0.20	7.00	+0,-0.30	0.40
16	+0.30,+0.70	h6	330	2.00	± 0.20	8.00	+0,-0.30	0.40
17	+0.30,+0.80	h6	330	2.00	± 0.20	8.00	+0,-0.30	0.47
18	+0.30,+0.80	h6	330	2.00	± 0.20	9.00	+0,-0.30	0.50
19	+0.30,+0.80	h6	330	2.00	± 0.20	9.00	+0,-0.30	0.50
20	+0.30,+0.80	h6	330	2.50	± 0.25	10.00	+0,-0.40	0.50
21	+0.30,+0.80	h6	330	2.50	± 0.25	10.00	+0,-0.40	0.50
22	+0.30,+0.80	h6	330	2.50	± 0.25	11.00	+0,-0.40	0.50
23	+0.30,+0.80	h6	330	2.50	± 0.25	11.00	+0,-0.40	0.50
24	+0.30,+0.80	h6	330	3.00	± 0.25	12.00	+0,-0.50	0.50
25	+0.30,+0.80	h6	330	3.00	± 0.25	12.00	+0,-0.50	0.50

单位 unit (mm)

DEWEI



浙江德威硬质合金制造有限公司

ZHEJIANG DEWEI CEMENTED CARBIDE MANUFACTURING CO.,LTD

地址:中国·浙江·乐清市芙蓉工业区

Add:Furong Industrial Park,Yueqing,Zhejiang,China

电话 (Tel):0086-577-62298508 62298502 62298577

传真 (Fax):0086-577-62298505

邮编 (P.C):325612

Http://www.cn-dewei.com

E-mail:sales@cn-dewei.com

DEWEI INTERNATIONAL

4126 Anson Drive, Hilliard, OH 43026

Tel: 614-969-7221

Fax: 800-886-0967

E-mail:howiehuang@deweiinternational.com